

## OWB-2G Installation Sheet

The OWB-2G is a wall box for mounting externally on a wall or other surface. It is suitable for housing any Kramer 2 gang, wall-mounted, EU device, such as, the WP-209 or the RC-53D.

The OWB-2G can be mounted such that the cables can enter either from the rear, left or right-hand side of the unit.

### To install the OWB-2G:

1. If the cables are to enter the OWB-2G from the side, carefully break off the plastic square that is on the side of the OWB-2G from which the cables will enter (circled in the drawing).

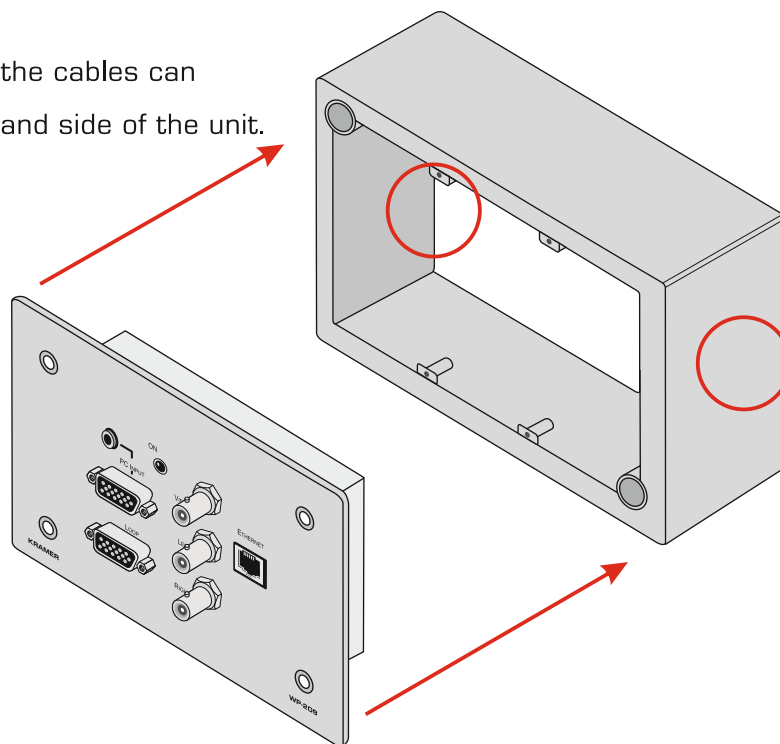

2. Feed the cables from the rear/side of the OWB-2G out through the front.
3. Hold the OWB-2G in position against the wall or surface on which it is to be mounted. Taking care that the OWB-2G is level, attach it using the four screws provided.
4. Connect the cables to the relevant connections on the wall plate.
5. Remove the four screws securing the face plate of the wall plate. Put the face plate and screws aside.
6. Insert the wall plate into the OWB-2G and secure the wall plate with at least four screws to the OWB-2G.
7. Replace the face plate removed in Step 5 and secure it with the screws.

