

HOLD MONITOR ARM¹⁸

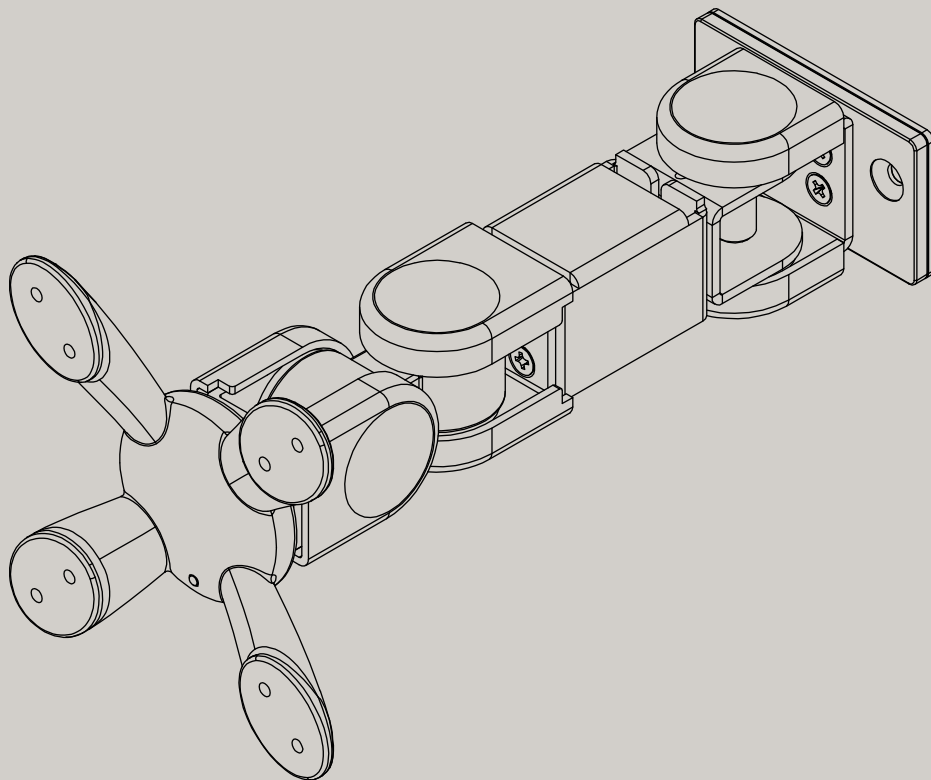

Dimensions

See user manual for assembly instructions.

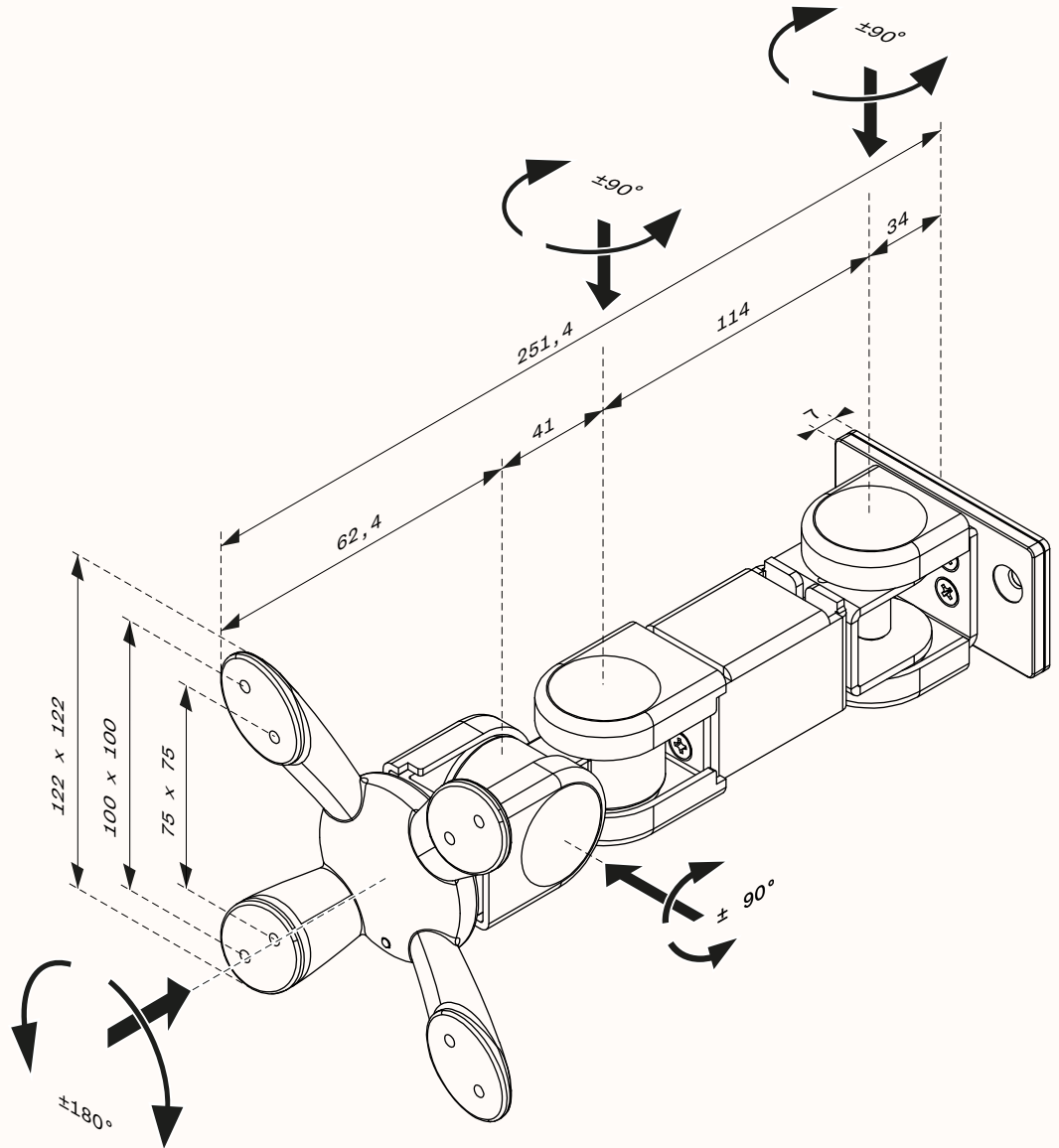

REAR VIEW

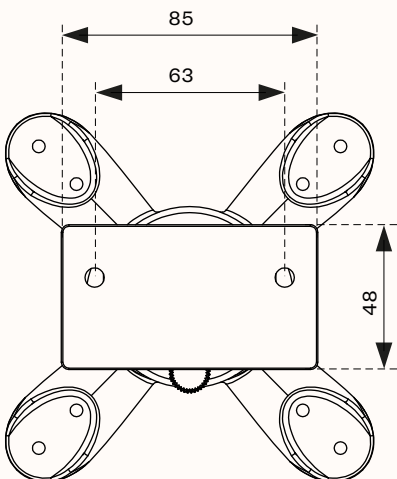

HOLD MONITOR ARM¹⁸

TRIPPEL JOINTED MONITOR MOUNT, VESA 75/100, RAIL MOUNTED, WHITE/SILVER

ART. NO

4481001801 WHITE RAL 9016
4481001802 SILVER

Technical data

MATERIAL	STEEL AND ALUMINIUM
FINISH	WHITE-MATTE, SILVER-METALLIC
MAXIMUM ARM LENGTH	251mm
MAX LOAD	8kg*
VESA	75/100

* Weight span is calculated based on monitor with Centre of Mass shorter than 30mm from VESA interface. For curved or bigger screens, the weight span might differ.